



This illustration is artists impression only

<b>LIVING AREAS</b>	FAMILY/ DINING	3750 x 6930
<b>BEDROOMS</b>	BED 1	3600 x 3300
	BED 2	3050 x 3100
	BED 3	3000 x 3100
	BED 4	2890 x 3000
<b>OUTDOORS</b>	LIVING	3240 x 3500
<b>TOTAL AREAS</b>	HOUSE	126.19m <sup>2</sup>
	GARAGE	38.04m <sup>2</sup>
	PORCH	2.18m <sup>2</sup>
	OUTDOOR LIVING	11.34m <sup>2</sup>
	TOTAL AREA	177.75m <sup>2</sup>
	TOTAL SQ	19.15sq.

25.02.2014

# PREMIER TURNKEY

## Wilkes 19

### Sovereign Facade

Lot 246 Perennial Drive - Stage 2B

# \$359,900

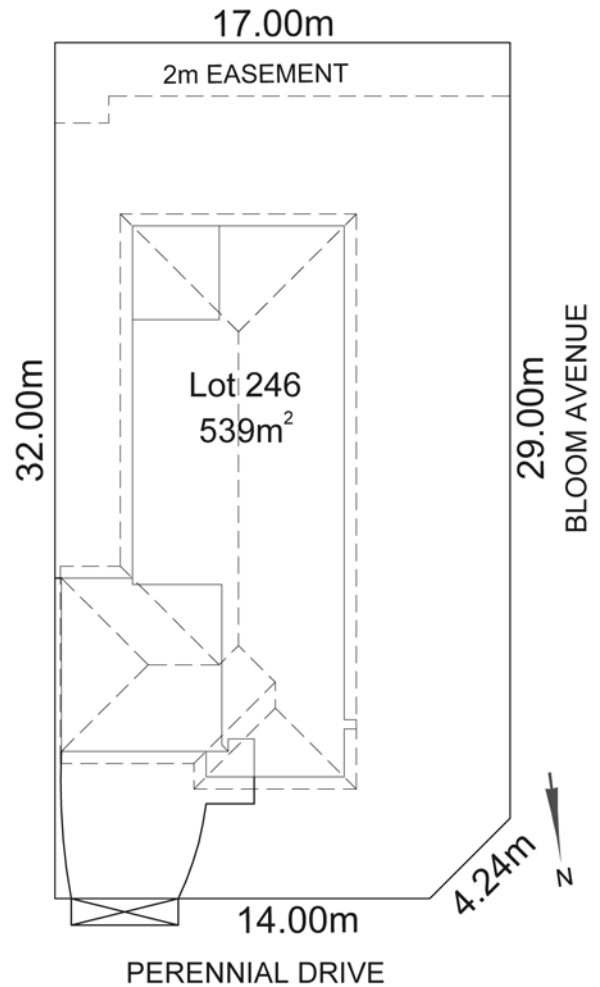

837439

**Pennyroyal**  
Coburns Road  
Kurunjang VIC 3337

**pennyroyal**  
at Kurunjang

**Empire**  
Property Investors