



LIVING AREAS	FAMILY/ DINING	3750 x 6930
BEDROOMS	BED 1	3600 x 3300
	BED 2	3050 x 3100
	BED 3	3000 x 3100
	BED 4	2890 x 3000
OUTDOORS	LIVING	3240 x 3500
TOTAL AREAS	HOUSE	126.19m <sup>2</sup>
	GARAGE	38.04m <sup>2</sup>
	PORCH	2.18m <sup>2</sup>
	OUTDOOR LIVING	11.34m <sup>2</sup>
	TOTAL AREA	177.75m <sup>2</sup>
	TOTAL SQ	19.15sq.

This illustration is artists impression only

28.01.2014

# PREMIER TURNKEY

## Wilkes 19

### Verve Facade

Lot 408 Stonehill Drive - Stage 4

# \$349,900

14.00m

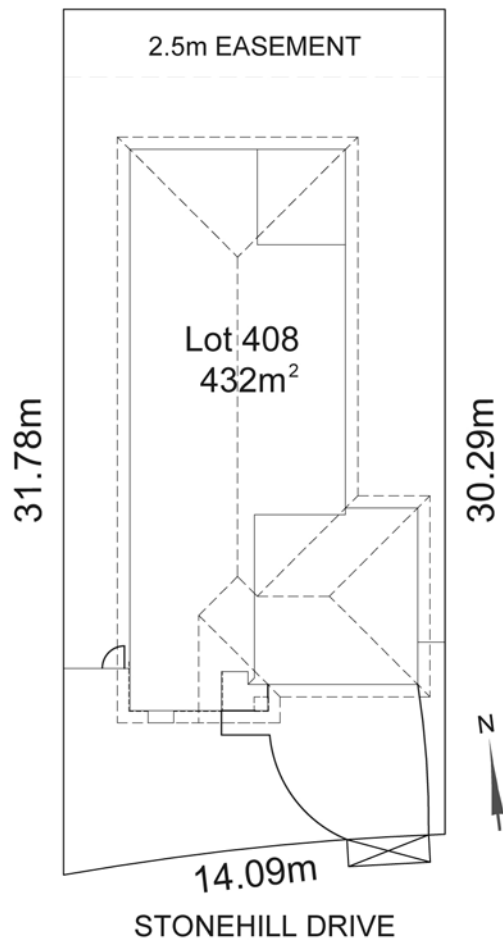

Stonehill  
Griffith Street  
Bacchus Marsh VIC 3340



Devine Homes reserves the right to amend specifications & prices without notice. Please ask the Devine sales consultant for clarification prior to purchase. All floor plans & facades are indicative conceptions & are not intended to be an actual depiction of the building, fencing, paths, driveway, alfresco entertaining or landscaping & are not necessarily to scale. All dimensions are approximate, refer to contract documentation for details. Working drawings take precedence over brochure. Terms, conditions, fees & government charges may apply. This is an advertisement only. Consumers may wish to consult their own investment advisor. This illustration is an artist's impression only. Devine Homes PTY LTD. Real Estate Licence D.M.B P/L No. 066777L. A.C.N 010 798 384. (\* Estate Specific)